



ELECTRIC BOILIE GRINDER

INSTRUCTION MANUAL

Please charge fully and read instructions prior to use.

- A** POWER BUTTON
- B** MICRO USB CONNECTOR
- C** CUTTING BLADE
- D** CONTAINER

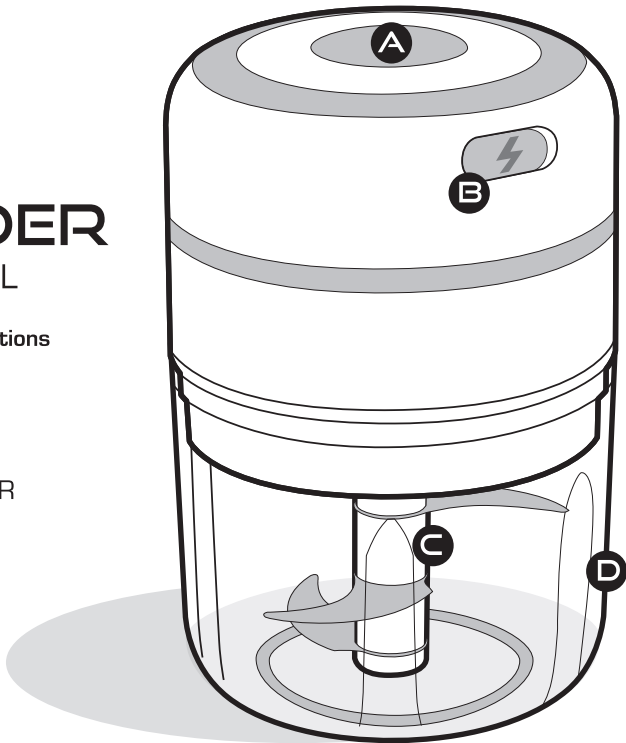

1. CHARGING

Important: Fully charge head unit prior to use.

Connect charging cable to the head unit and USB power source. The power button will glow red during the charging process. When the head unit is fully charged the power button will change to blue.

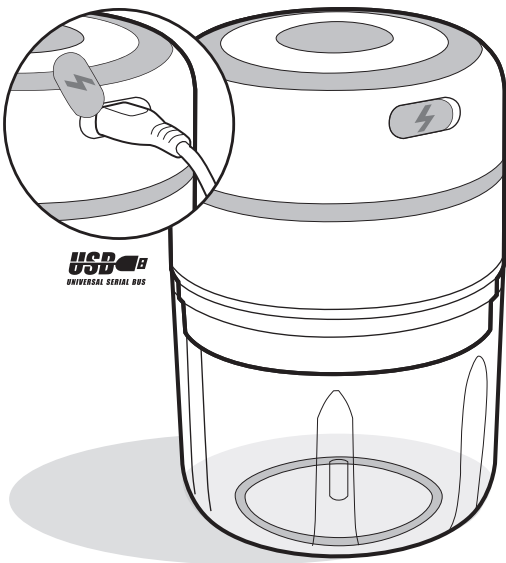

2. CUTTER INSTALLATION

Install cutter as shown. **Do not touch the blades directly, hold cutter by plastic spindle.**

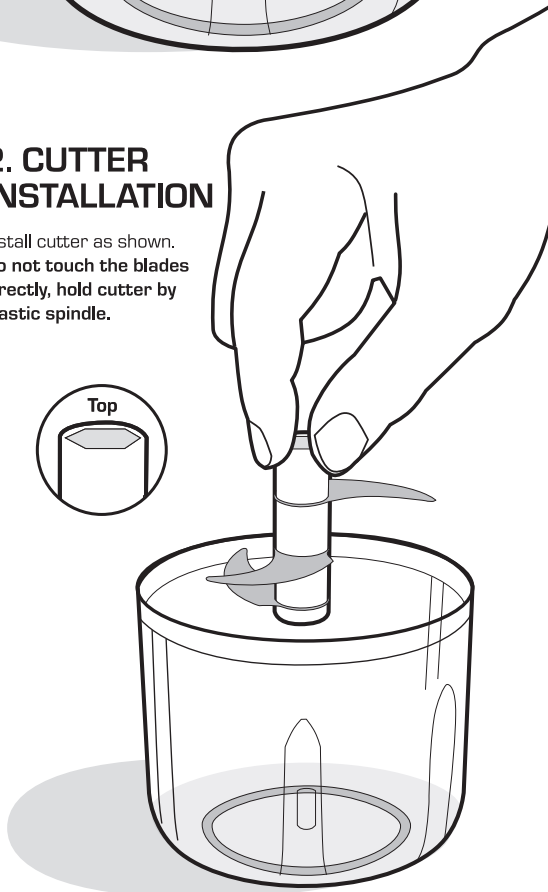

SPECIFICATIONS

Model No.:	EG-0947
Rated Capacity:	250ml
Battery Voltage:	3.7V
Rated Current:	1.2A
Rated Power:	30W
Running Time:	Max 30s
Input Voltage:	5V/1200mAH
Input Current:	1A

INDICATOR GUIDE

Charging	Continuous Red Light
Fully Charged	Continuous Blue Light
Ready-to-Use	Blue Light Flashes 5 Times
Safety Switch Off	Red and Blue Lights Flash Twice Respectively
Working	Continuous Blue Light up to 30 seconds
Low Power	Continuous Red Light for 10 seconds

PRECAUTIONS

- Ensure the head unit is fully charged prior to use.
- Ensure the cutter is installed correctly.
- **Do not overfill.** Upper blade indicates fill level.
- Do not use with frozen or hard baits (eg. Halibut Pellets or frozen Boilies).
- Only use the head unit with the supplied container.
- Allow head unit to cool fully after prolonged use. 30 seconds - allow to rest for 2 minutes, 3 x 30 seconds - allow to rest for 30 minutes.
- Keep out of reach of children.
- Personal use only - not for commercial usage.
- **Important:** Fully charge the Head Unit at least once every three months to maintain battery life.

CLEANING & MAINTENANCE

- Clean Cutter, Catch Container and Head Unit after use.
- Handle carefully, do not touch or hold the cutter by the blades. Hold spindle to avoid injury.
- Clean head unit with a damp cloth, do not submerge in water.
- Clean catch container in clean warm water; do not use abrasive cleaners or cloths.
- Do not place in dishwasher.
- Wipe all components with a dry cloth after cleaning.
- Reassemble components for storage.

3. ADDING BAIT

Once cutter is installed, add bait as required making sure not to overfill. Upper blade indicates fill level.



4. CONNECT THE HEAD UNIT

Attach head unit as shown, making sure to align head and container recesses. Once fitted correctly the power button will flash 5 times to indicate the Head Unit is fitted correctly and is now ready-to-use.

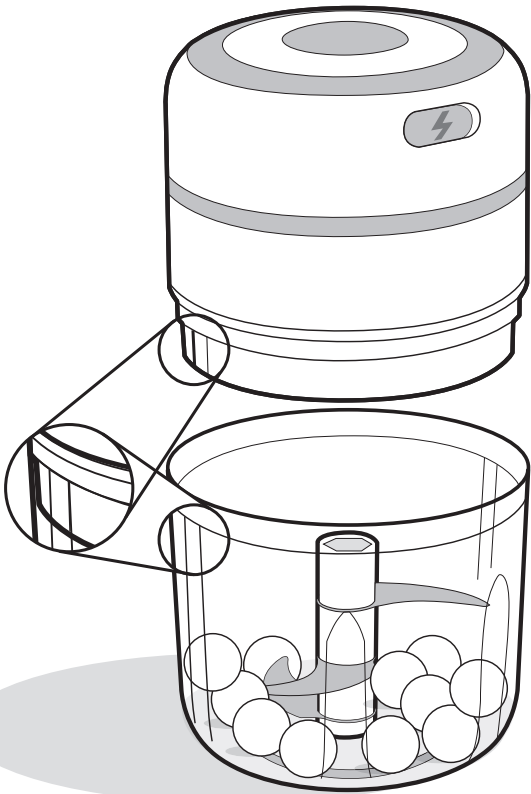

5. GRINDING INSTRUCTIONS

Press the power button to activate the grinder; hold the button until the desired consistency is achieved. For best results press and hold the power button for a few seconds at a time.

The head unit has a built-in anti-overheating setting which will automatically stop working after 30 seconds.

TROUBLE SHOOTING GUIDE

Follow the recommended charging, filling and cleaning advice to avoid faults. Do not try to disassemble or repair the Head Unit.

FAULT	INDICATOR	CAUSE	SOLUTION
Fails to operate after assembly	Alternate flashing red and blue lights	Head unit not seated correctly	Properly install Head Unit on Catch Container
	Red light stays on	Low battery power	Charge Head Unit
	Blue light stays on	Motor is stuck or damaged	Manually rotate the Head Unit shaft. If the problem persists return the item to retailer for inspection.
Charging	No light	Loose charging cable	Replace charging cable
Head Unit emits a smell during operation		Normal for new Head Unit	If the problem continues to persist, return the item to the retailer for inspection.
Stuck blades		Blade is entangled or stuck in bait	Remove Head Unit and carefully remove the obstruction(s).